



# Evolution 330 SL

## “Australia’s Most Innovative A Class Motorhomes “

Every Wirraway Motorhome is fully custombuilt, every one is different and all brilliantly designed by passionate motorhomers and are handbuilt by dedicated staff. This layout was specified by the new owners.

### Snapshot Specs!



Unique & Innovative PSU - Electronic Computer Control and Automatic Management of:  
Power & Charging Systems, Solar Panels, Generator, Climate Controlled Airconditioning, Security Lighting and Water Tank Filling

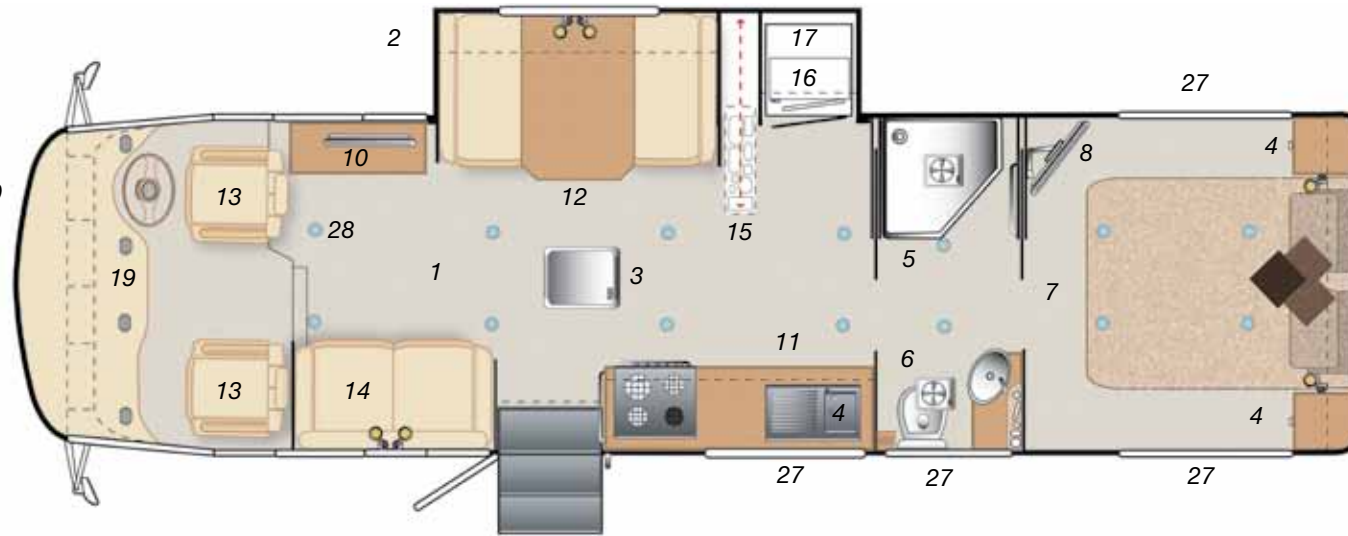

Wirraway's unique and innovative heavy duty remote controlled, automatic locking storage drawer and service hatch system

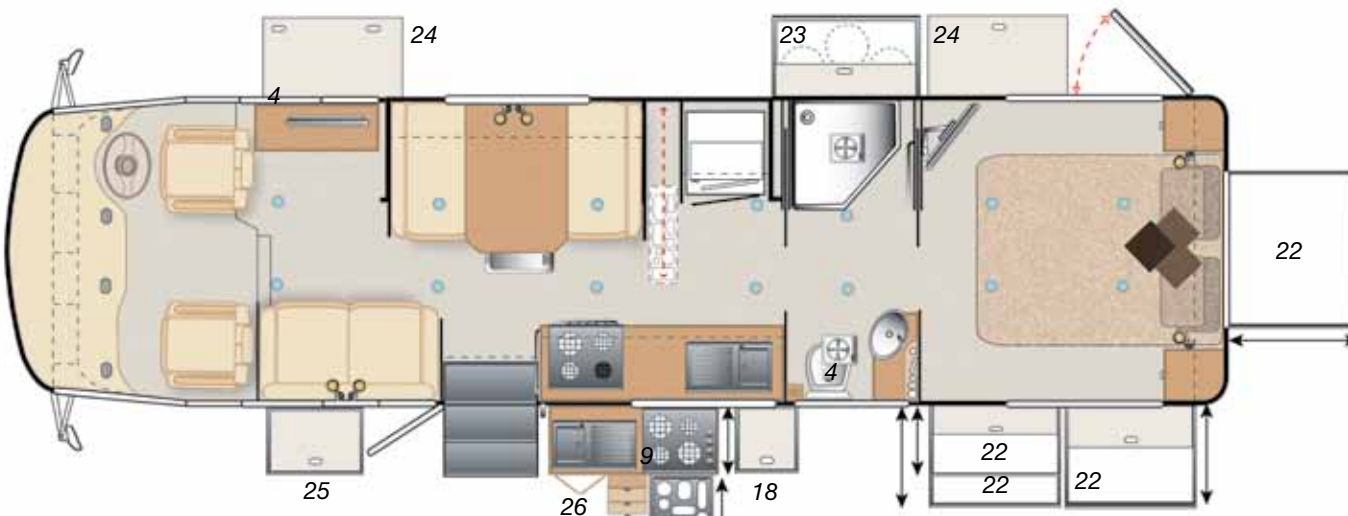

Mercedes Chassis with Airbag Suspension and 2 Year Unlimited km Warranty & Service Network

- 1 Spacious Interior with Lavish Fittings & Opulent Appointments
- 2 Large " Living Slideout"
- 3 Dual Zone Reverse Cycle Airconditioners
- 4 Bedside tables, drawers 4 robes
- 5 Separate Shower with fan hatch
- 6 Separate Toilet with fan hatch
- 7 Large Private Bedroom with 2 robes & bedside tables
- 8 HD 22" LCD TV Bedroom
- 9 Generous overhead cupboards
- 10 HD 32" LCD TV in Livingroom
- 11 Designer Kitchen with s/s sink, stove, oven and grill
- 12 Large Dinette in Full Leather
- 13 Leather Captains Chairs
- 14 Leather 2 Seat lounge
- 15 Full Height Slideout Pantry
- 16 27lt Microwave Oven
- 17 Dometic 184 lt Fridge
- 18 Dometic Front loading washer
- 19 Drivers Cockpit with Cruise Control - Satellite Nav', UHF-VHF Radio & Colour Reversing - Infrared Camera
- 20 Unique & Innovative PSU for Power, Charging & Electrical Management
- 21 Hose Reel incorporating Automatic Tank Filling
- 22 Remote Locking Automatic Storage Drawers
- 23 Auto Changeover LPG Cylinders 3 x 4.5kg
- 24 Onan 3.6 kva Diesel internal start generator
- 25 4 x 120 Amp Hour 12V deep cycle batteries
- 26 Full Rollout Kitchen
- 27 Large Tinted Double Insulated Windows throughout
- 28 Full 12v system with LED lighting inside and out

For More Information Contact Our Sales Team

Wirraway Motorhomes, 6 Hynes Court, Mildura Vic 3500 - Phone / Fax: (03) 50 230 230 - E: wirraway@ncable.com.au - www.wirraway.com.au



# Evolution 330 SL

Australia's Most Innovative A Class Motorhomes"

## WIRRAWAY MOTORHOMES - EVOLUTION MODEL STANDARD SPECIFICATIONS

Overall Length: 10.058m (33'0") Overall Width - including Awning: 2485mm (8'1")  
Overall Height: 3.5m (11'5") Internal Room Height: 2.0m (6'6")

### AUTOMOTIVE

Automotive GMV: 12,000kg  
Chassis: Mercedes  
Engine: 6.73litre in line 6cyl turbo charged with direct injection diesel  
Transmission: 6 speed Automatic  
Wheels: 19.5 x 6.75 steel, dual rear wheels  
Tyres: 265/70 R 19.5 tyres  
Brakes: Front and rear ABS Disc Brakes with exhaust brake  
Steering: Recirculating ball with integral power assistance  
Suspension/Axles: Airbag Suspension with remote control.  
Levelling System: Fully automatic electric Levelling Legs also with manual mode  
Cab AC: In dash Air conditioning  
Fuel: Diesel, 325 litre fuel tank  
Reversing Camera: Colour LCD screen, with Infrared Night Vision & inbuilt Microphone  
Cruise Control: Standard  
Power Steering: Standard  
Cockpit: GPS - Satellite Nav & Fully Instrumented trimmed dashboard  
Mercedes Warranty: 2 Year - Unlimited km with nationwide warranty & service network

### STRUCTURAL

Frame: 12mm plywood flooring, Aluminum RHS Box Section Frame Chassis  
Upper Wall Panelling: Composite high thermal efficiency Styrofoam / fibreglass vacuum sealed, high strength, fire retardant, rot proof panels

### ELECTRICAL/HEATING/AC/PLUMBING

Electronic System: Onboard EC325 Power Supply & Battery charging Unit with remote digital control panel, Solar BP 80w panel, 2000w Inverter,  
Generator: Onan 3.6kva internal start generator.  
House Batteries: 4 x 120 Amp Hour 12V deep cycle  
Vehicle Batteries: 2 x12V 115 Amp Hour  
Alternator: 14V - 80 Amp  
Battery Charger: 25 Amp automatic smart battery charger & alternator charging  
240v Power: All 240v power has circuit breaker with earth leakage protection  
240V Power Points: External power point, city power connection with adequate internal power points where you need them  
12V DC Power Points: 3 x 12V Powerpoints, Bedroom, Dining Table & Computer Console  
12V Lighting: LED down lights, reading lights and fluorescent lights  
Air Conditioning: 2 x Roof-top 13,500 BTU with 5,600 BTU heating  
Ducted Heating: Webasto diesel heating ducted throughout  
Gas: 3 x 4.5kg cylinders with changeover gas regulator  
Hot Water: Electric start Gas / or 240v hot water service  
Fresh Water: 330lt with electronic level monitoring & digital display  
Grey Water: 200lt with electronic level monitoring & digital display  
Drinking Water: Filtered cold water delivery to the kitchen

### APPLIANCES - ACCESSORIES

Refrigerator: Dometic RM4605 Automatic selecting 184lt three way tropical fridge.  
Cooking: 3 burner, 1x 240v electric stove top, grill, oven - push button ignition  
Microwave: Stainless steel Sharp 27lt microwave oven  
Sink: Stainless steel single bowl - drainer - tinted glass lid / splashback  
Televisions: 12V - HD LCD Flat Panel TVs with DVD player & PC connections  
Automatically actuated 32" in lounge, wall mounted 22" in the bedroom  
TV Antenna: Fully automatic Winegard Sensor HD amplified antenna  
Radios: AM/FM radio plus a UHF - VHF for on road communication  
DVD Sound System: Remote Controlled - High quality DVD/CD stereo  
Separate Bathroom: Full fibreglass shower cubicle with pivot shower door,  
Separate Toilet: Vanity basin, large mirror, towel rails & robe hooks, overhead cupboards  
Vacuum flush cassette toilet (with black water tank)  
Ventilation: Rangehood, Roof Hatches in kitchen & bathroom, shower & toilet  
Special Inclusions: Front loading Washer / Dryer, Automatic  
Slideout Room: Large Slideout Living Room, weatherproof construction above floor level, triple weather seals, heavy duty electric motor, manual override

### Outdoor Kitchen:

Full slideout kitchen includes: utility drawers, cupboards, Stainless steel single bowl sink with drainer, stainless steel 4 burner gas cooktop, Waeco Drawer - fridge/freezer, hot & cold water

**Storage Drawer System:** 5 automatic remote locking slideout storage drawers with locking tabletop lids for under bed storage, full outdoor kitchen, 3x gas bottles, 3x large drawers for camping equipment ,4 automatic remote locking service lockers for front loading Dometic washing machine, Onan generator house batteries, hot water service and water management station, sanitation

### Other Inclusions:

Full 12v system with LED, reading, strip, down lights inside and LED annex lighting outside, electric entry step, fire extinguisher, smoke and CO detectors, outside shower, aluminum bumper

### INTERIOR/EXTERIOR DECOR

Windows: Double laminated windows incorporating adjustable fly screens with highly functional, reflective privacy blinds  
Exterior Finish: Fully coated with high quality TWO PACK epoxy paint  
Awning: Full length roll out color coordinated electric awning  
Window Coverings: Designer curtains with timber pelmets throughout  
Motorhome Seating: 2 full leather captains chairs, matching dinette & 2 seat leather lounge  
Bedding: Luxury double innerspring mattress, bedspread scatter cushions. Lift up bed, high lift Gas struts & easy access to vast under bed storage  
Solid timber doors and auto locking draws  
Cabinetry: High Quality wall covering  
Interior Walls: Quality Vinyl flooring throughout  
Floor Coverings: High quality domestic fittings & fixtures throughout  
Fixtures: Expansive bench tops, extensive overhead cupboards and a large floor to ceiling roll out pantry next to the fridge  
Also Includes: Bull bar, Tow bar, black water tank, carpeting & alternate graphics packages  
**Optional Extras (P.O.A.)** Automatic Satellite dish for nationwide TV reception

*With Wirraway's policy of continual improvement, you may notice some differences in Photos, Layout or Specifications that are subject to change without notice.*

*Ask us for more details or refer to our supporting documentation for more information!*

## For More Information Contact Our Sales Team

Wirraway Motorhomes - 6 Hynes Court, MILDURA VIC 3500

Ph/Fax: 03 50 230 230 - E: wirraway@ncable.com.au - www.wirraway.com.au

